

How to Customize QR Codes with External Software (Avery Design & Print)

help.fracttal.com/hc/en-us/articles/35151309068941-How-to-Customize-QR-Codes-with-External-Software-Avery-Design-Print

To create customized labels with QR codes for assets registered in Fracttal One, you can use **Avery Design & Print**, a free online design tool. With this platform, it is possible to import data exported from Fracttal One and generate labels with QR codes conveniently. Below, we detail the complete process to export the data and customize your labels.

Customizing QR Codes in Avery Design & Print

Step 1: Export Data from Fracttal One

Access the **"Catalogs"** module in Fracttal One and select the **"Equipment"** option. Within this section, you will find the list of all assets registered on the platform. Select the assets whose QR codes you want to print.

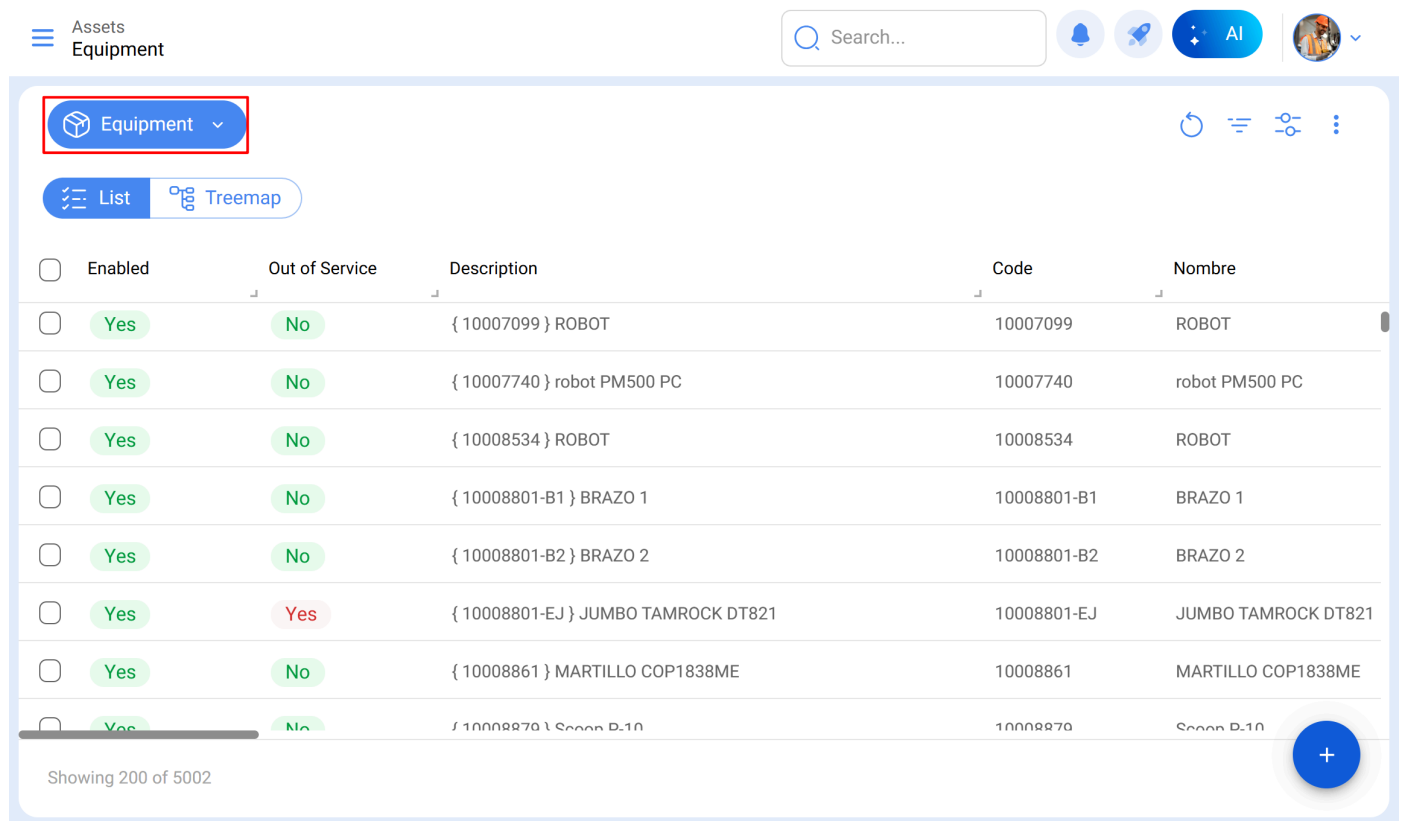

The screenshot shows the Fracttal One interface for the Equipment catalog. At the top, there is a search bar and navigation icons. Below the search bar, the 'Equipment' category is selected and highlighted with a red box. The interface shows a list view of assets with the following columns: Enabled, Out of Service, Description, Code, and Nombre. The 'Enabled' column contains green 'Yes' buttons, and the 'Out of Service' column contains green 'No' buttons, except for one row which has a red 'Yes' button. The 'Description' column contains asset identifiers and names, such as '{ 10007099 } ROBOT' and 'robot PM500 PC'. The 'Code' column contains numerical codes, and the 'Nombre' column contains the asset names. At the bottom left, it says 'Showing 200 of 5002'. At the bottom right, there is a blue circular button with a white plus sign.

Enabled	Out of Service	Description	Code	Nombre	
<input type="checkbox"/>	Yes	No	{ 10007099 } ROBOT	10007099	ROBOT
<input type="checkbox"/>	Yes	No	{ 10007740 } robot PM500 PC	10007740	robot PM500 PC
<input type="checkbox"/>	Yes	No	{ 10008534 } ROBOT	10008534	ROBOT
<input type="checkbox"/>	Yes	No	{ 10008801-B1 } BRAZO 1	10008801-B1	BRAZO 1
<input type="checkbox"/>	Yes	No	{ 10008801-B2 } BRAZO 2	10008801-B2	BRAZO 2
<input type="checkbox"/>	Yes	Yes	{ 10008801-EJ } JUMBO TAMROCK DT821	10008801-EJ	JUMBO TAMROCK DT821
<input type="checkbox"/>	Yes	No	{ 10008861 } MARTILLO COP1838ME	10008861	MARTILLO COP1838ME
<input type="checkbox"/>	Yes	No	{ 10008870 } SCAPO B-10	10008870	SCAPO B-10

Click on the **"Export"** option. The system will generate an Excel file with the data of the selected assets.

Assets
Equipment

Search...

(4) Selected

List Treemap

Enabled	Out of Service	Description	Code
<input checked="" type="checkbox"/> Yes	<input type="checkbox"/> No	{ 10001077 } JUMBO XL3	10001077
<input checked="" type="checkbox"/> Yes	<input type="checkbox"/> No	{ 10001426 } GRÚA	10001426
<input checked="" type="checkbox"/> Yes	<input type="checkbox"/> No	{ 10007099 } ROBOT	10007099
<input type="checkbox"/> Yes	<input type="checkbox"/> No	{ 10007740 } robot PM500 PC	10007740
<input type="checkbox"/> Yes	<input type="checkbox"/> No	{ 10008534 } ROBOT	10008534
<input type="checkbox"/> Yes	<input type="checkbox"/> No	{ 10008801-B1 } BRAZO 1	10008801-B1
<input type="checkbox"/> Yes	<input type="checkbox"/> No	{ 10008801-B2 } BRAZO 2	10008801-B2

Showing 200 of 5002

Open PDF
Export
Bulk export data
Print QR
Import
Delete Imported Data
Fields Configuration
Clone Asset
Batch Edition

- Open the exported Excel file and create a new sheet.
- Copy the data you want to include on the label, such as the **QR Code URL**, **Code**, **Name**, and **Brand**.

	A	B	C	D
1	QR Público	Código	Nombre (C)	Marca (C)
2	https://one.fractal.com/qr/3e9b6c4c-ec7f-4363-bdb6-7277bc571178	0000-4	VENTILADOR MECANICO	MAQUET CRITICAL CARE
3	https://one.fractal.com/qr/1c5dcc5e-c527-4f6d-8f21-19b31cdf6eb1	000-2	VENTILADOR MECANICO	ARYZTA
4	https://one.fractal.com/qr/e14781cd-43e8-49f3-a570-e1d5d71c98e8	000-3	VENTILADOR MECANICO	ARYZTA
5				

- Make sure the sheet with the data is the only one in the file.
- Open the Excel file and organize the columns as needed. Make sure to include the column with the QR Code URL (automatically generated by Fractal One), as well as additional information such as any other data you want to include on the labels. Then, save and close the file.

Step 2: Access the Avery Design & Print Website

Open your browser and go to the [Avery Design & Print](#) website.

The Most Trusted Name in Labels

Fast. Easy. 100% Satisfaction Guaranteed.

1 - TYPE

2 - FORMAT

3 - SHAPE

BLANK LABELS

CUSTOM PRINTED LABELS

✓ No Minimum Orders

✓ Free Templates & Designs

✓ Free Shipping Over \$50



- Log in or create an account if you don't have one yet.
- From the homepage, scroll down until you find the **"Start Designing"** option, which will give you access to the design platform.

Design & Customize for FREE

With our free online design tool, you can easily create and print.

[START DESIGNING](#)

[Learn More >](#)

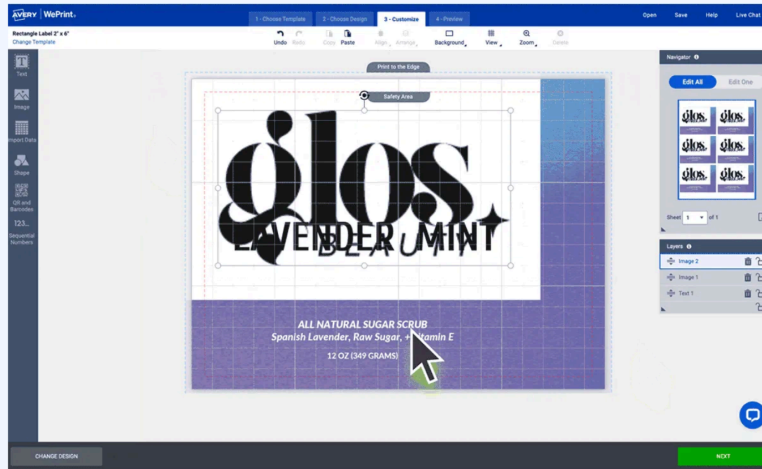

PREMIUM QUALITY



100% SATISFACTION GUARANTEED



NEED HELP? (800) 462-8379



Step 3: Create a New Label Design

- Choose the type of label you want to create. You can opt for standard adhesive labels or labels of a specific size.
- To find the correct label model, click on "**Custom Printing**" in the sidebar or enter the reference number of the label you are using.

1 - Choose Template 2 - Choose Design 3 - Customize 4 - Preview Open Save Help Live Chat

Print Yourself Custom Printing

View All

Sheet Labels

- Rectangle Labels
- Address Labels
- Shipping Labels
- Packaging Shapes
- Round Labels
- Oval Labels
- Square Labels
- Arched Labels
- Scallop Labels
- Star & Starburst Labels
- Heart Labels
- Lip Balm Labels
- CD & DVD Labels
- Name Tags & Badges
- Industrial & GHS
- Stickers
- Cards

Enter Any Size OFF 69 Templates Available

Preview	Size (in) ↑	Template Description ↑	Layout ↑
	2/3" x 1 3/4"	Rectangle Label	48/sheet
	1" x 2 5/8"	Rectangle Label	24/sheet
	2" x 4"	Rectangle Label	8/sheet
	3 1/3" x 4"	Rectangle Label	6/sheet
	3" x 4"	Rectangle Label	6/sheet

BACK



Click on the desired option to continue and choose the label design. You can opt to use pre-designed templates or start a design from scratch.

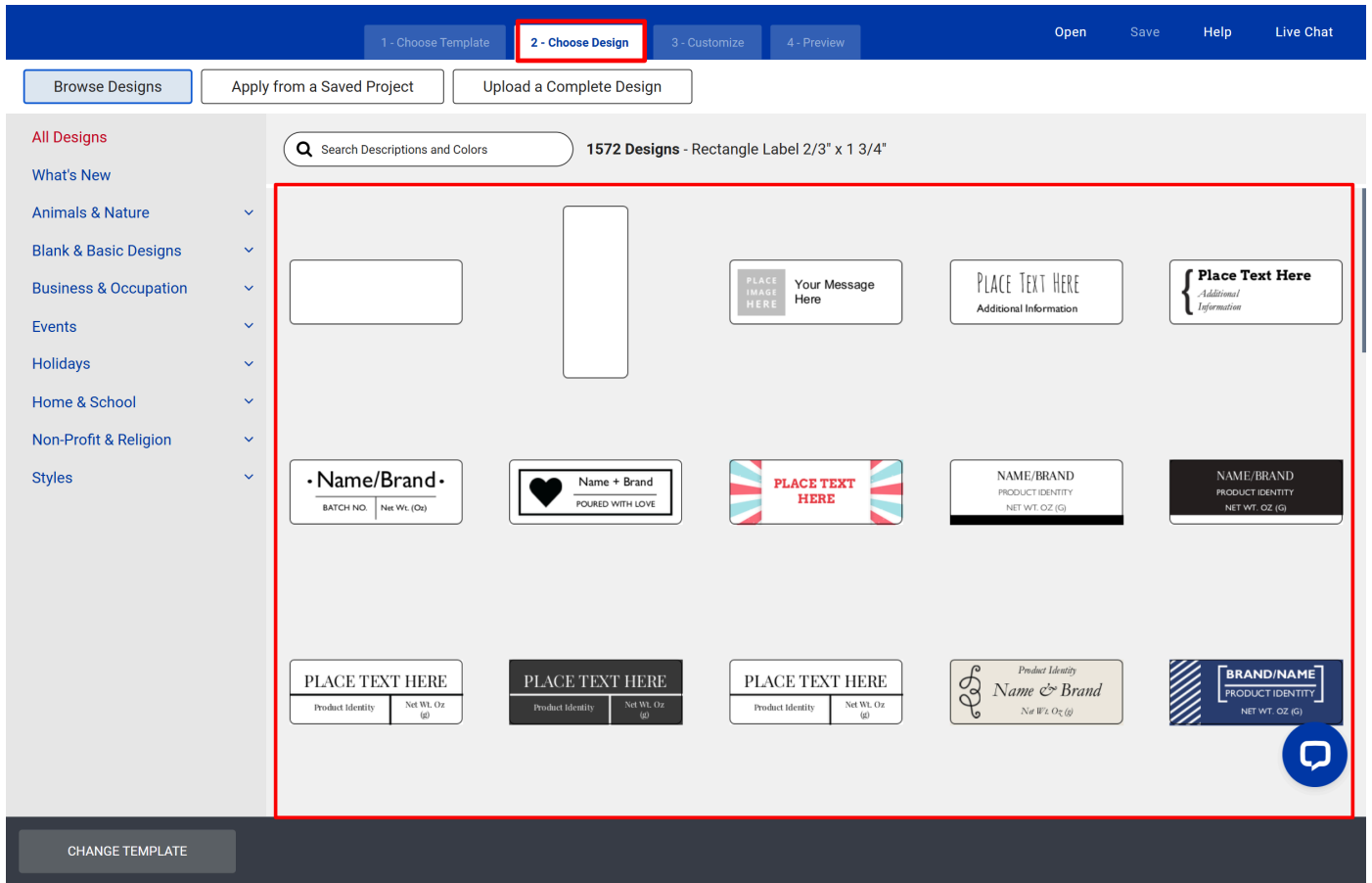

Step 4: Import Data into Avery Design & Print

- In the design panel, go to the left side menu and click on "QR Codes and Bar Codes"
- Click on "Add QR/Bar Code".

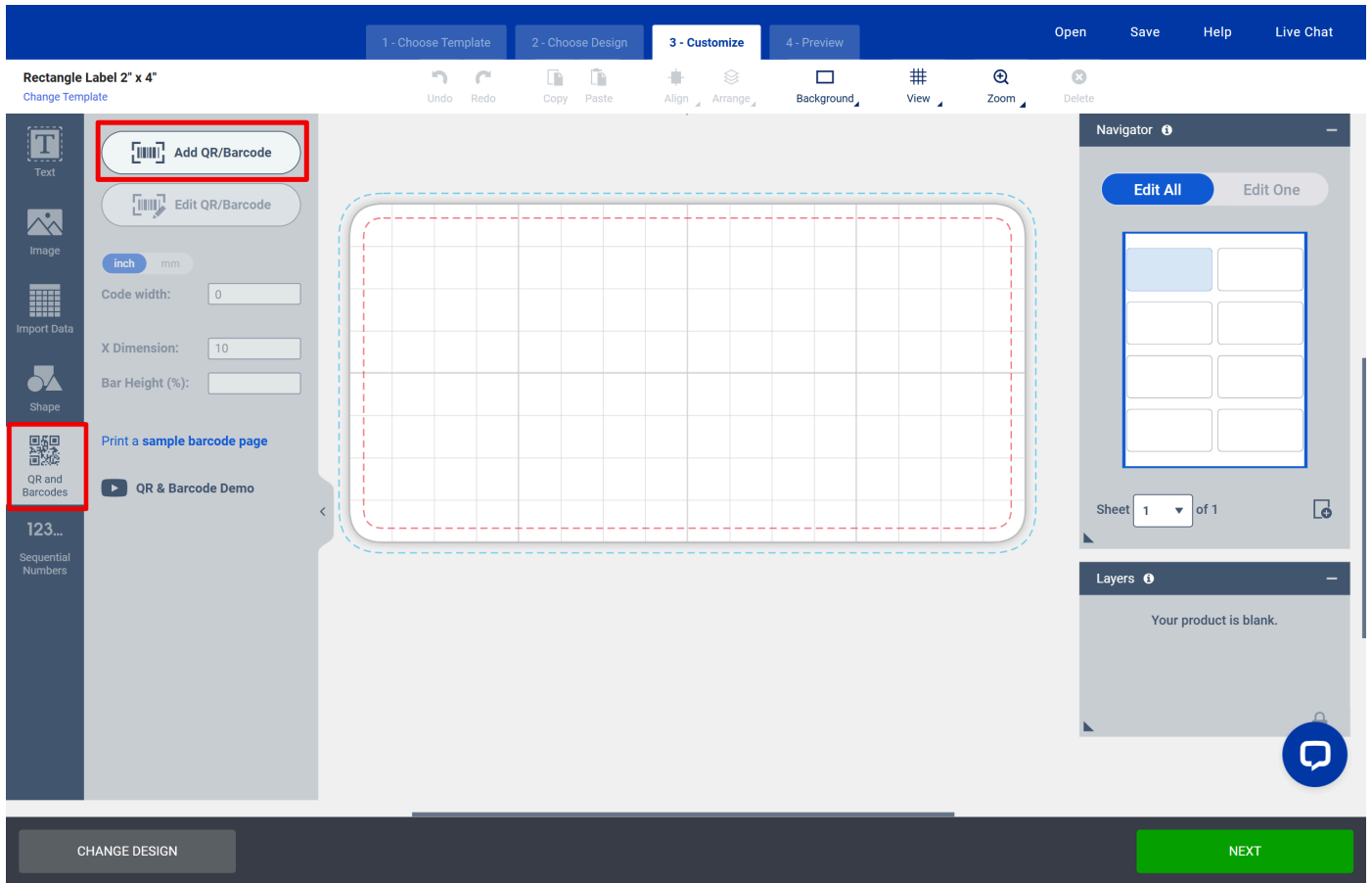

Choose Spreadsheet: select the data import source as "Spreadsheet".

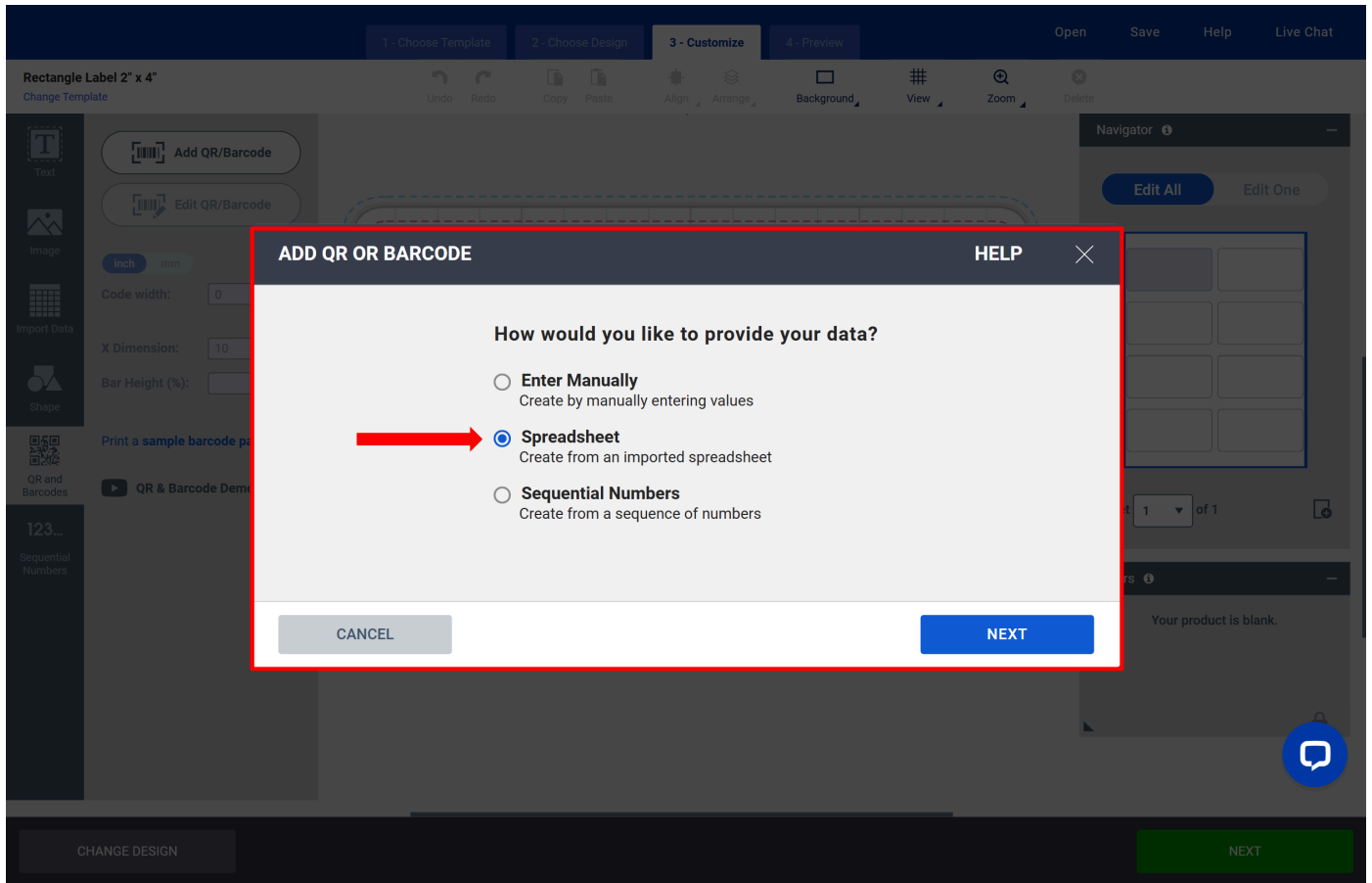

A tab will appear for you to select the Excel file exported from Fracttal One.

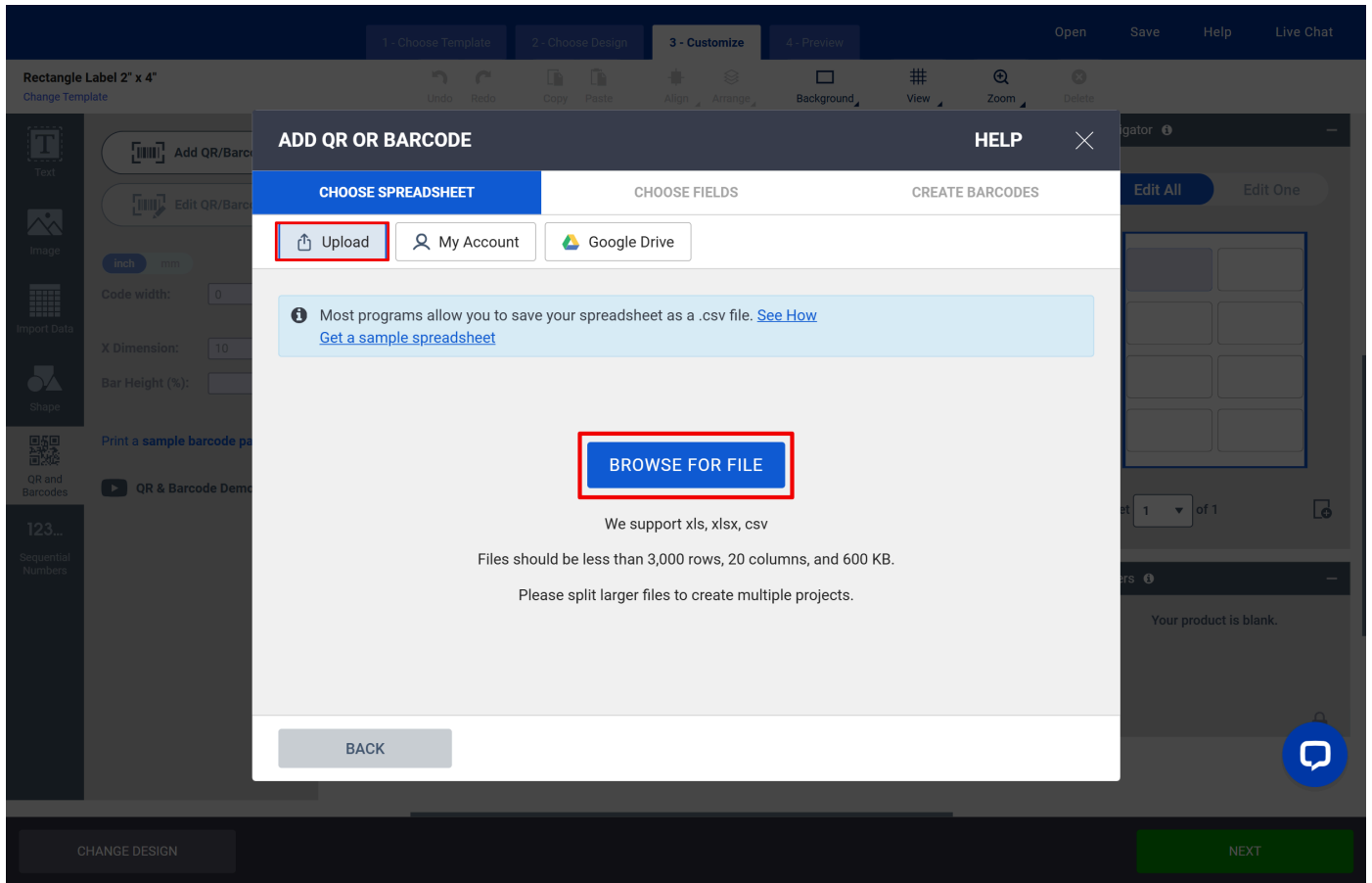

Choose Fields: select the fields you want to import by checking or unchecking the options as needed, then click **"Next"** to continue.

1 - Choose Template 2 - Choose Design 3 - Customize 4 - Preview Open Save Help Live Chat

Rectangle Label 2" x 4"
Change Template

Undo Redo Copy Paste Align Arrange Background View Zoom Delete

ADD QR OR BARCODE HELP X

CHOOSE SPREADSHEET CHOOSE FIELDS CREATE BARCODES

Choose the rows and columns you want to print

export (6).xlsx Replace Spreadsheet

If the first row contains your column titles, uncheck this box so they do not print.

#	Select All	<input checked="" type="checkbox"/>	↑ ↓	<input checked="" type="checkbox"/>	↑ ↓	<input checked="" type="checkbox"/>	↑ ↓
1	<input type="checkbox"/>	Código	Nombre (C)	Url Código QR			
2	<input checked="" type="checkbox"/>	00001-2	FA mantenimiento J	https://app.fracttal.com/#inve...			
3	<input checked="" type="checkbox"/>	0000-4	VENTILADOR MECANICO	https://app.fracttal.com/#inve...			
4	<input checked="" type="checkbox"/>	070128	BOMBA SUMERGIBLE	https://app.fracttal.com/#inve...			
5	<input checked="" type="checkbox"/>	070129	BOMBA SUMERGIBLE	https://app.fracttal.com/#inve...			
6	<input checked="" type="checkbox"/>	080167	MOTOR	https://app.fracttal.com/#inve...			

BACK NEXT

CHANGE DESIGN NEXT

Create Barcodes: fill in the fields related to the data you want to customize on the labels, organizing them according to your needs.

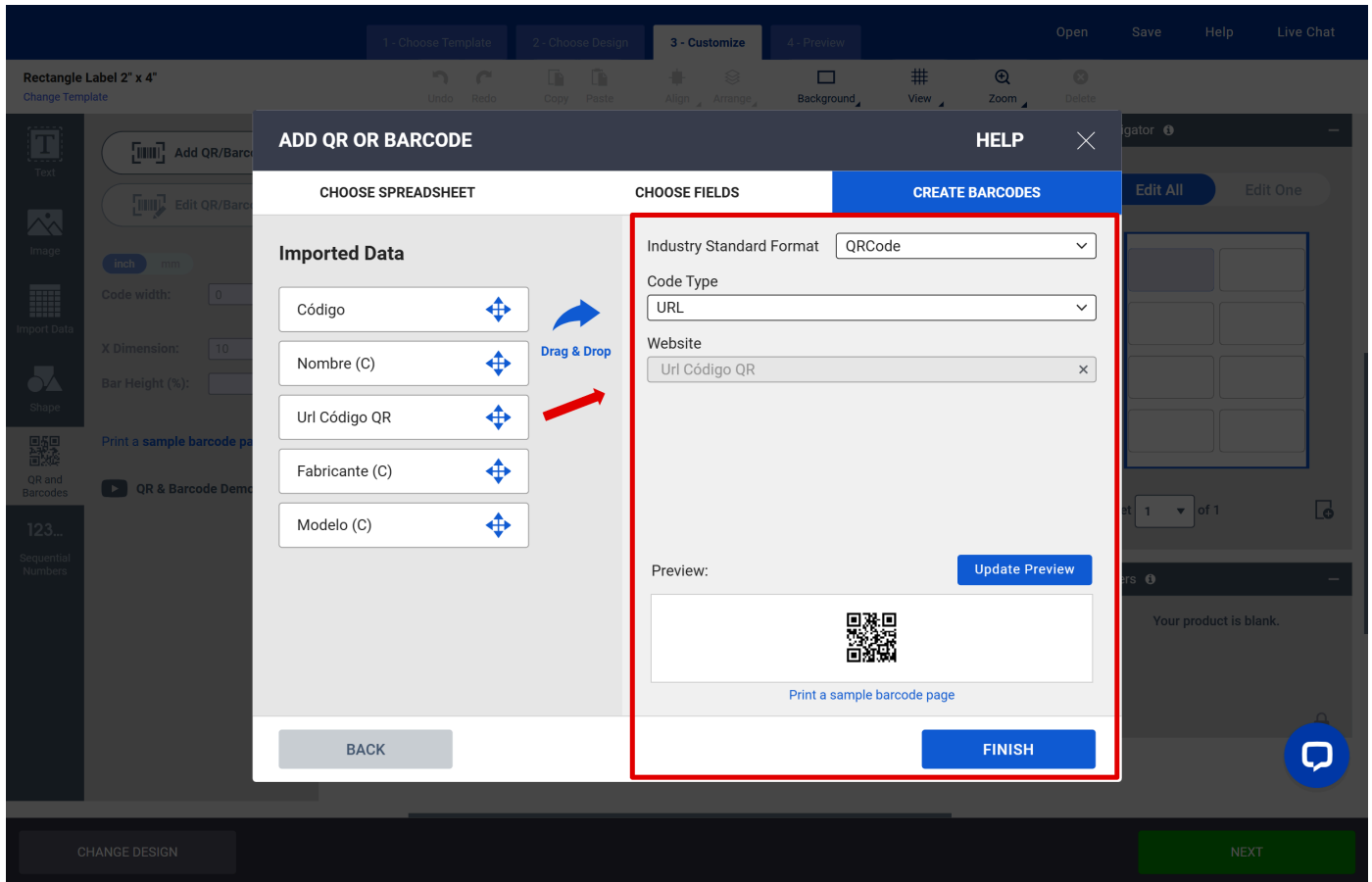

- On the left side, you will see the order of the columns corresponding to the exported Fractal file, which contains the asset information.
- In **Industry Standard Format**, select **QR CODE**.
- In **Code Type**, select **URL**.
- Drag the **QR Code URL** option from the left menu and drop it into the **Website** field.
- Click **Update Preview** to refresh the changes and then click **Finish**.

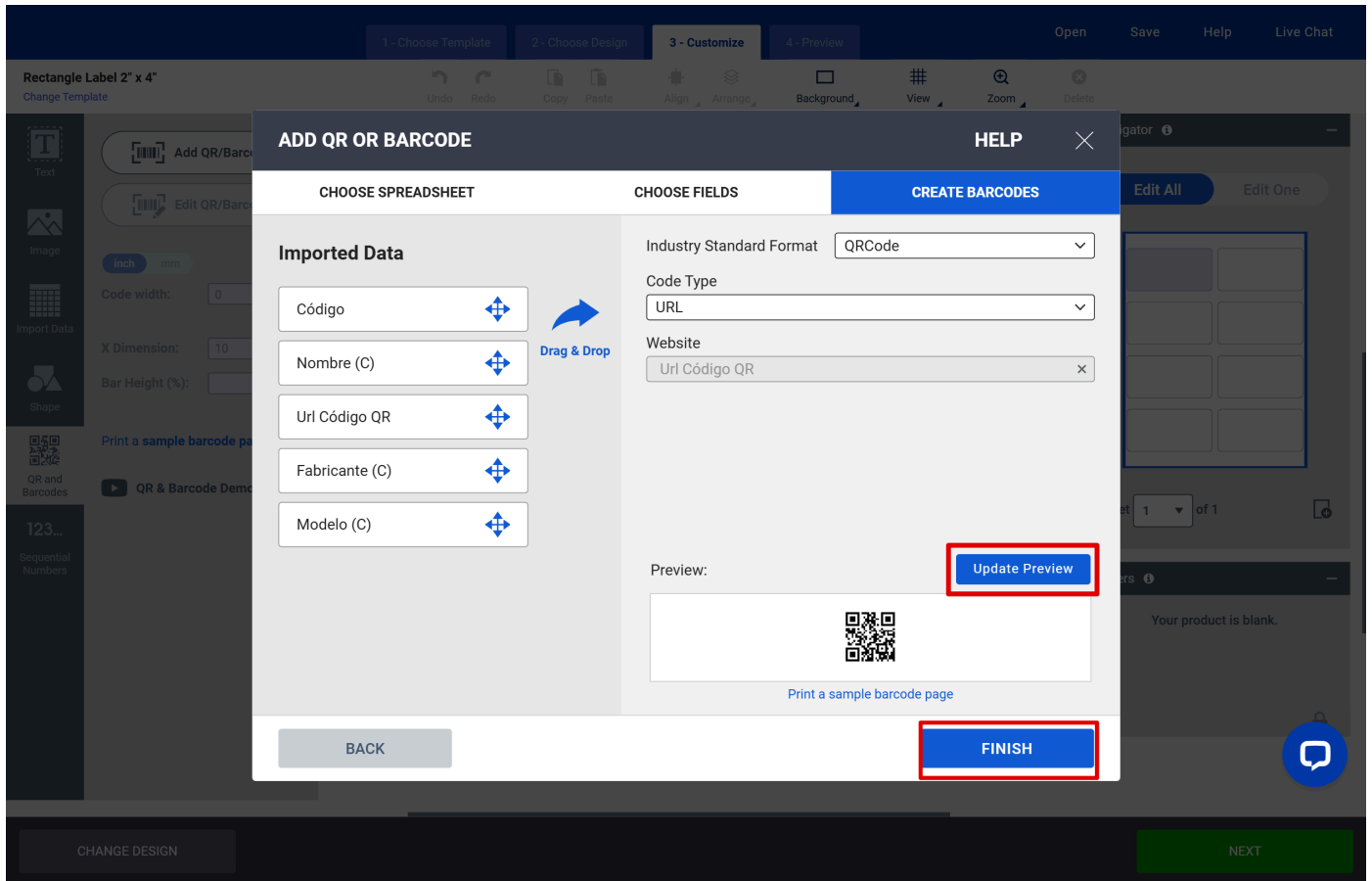

Once redirected to the design page, you will see the QR code inserted into the template. It is recommended to test the code's functionality to ensure it is correct and leads to the asset information in Fractal One.

Step 5: Insert Elements

- With the data imported, drag and drop the desired fields onto the labels.
- Drag the QR code image to position it strategically within the indicated area.
- In the "**Import Data**" menu, add other relevant information such as asset name, code, among others, by dragging data columns to the label areas.

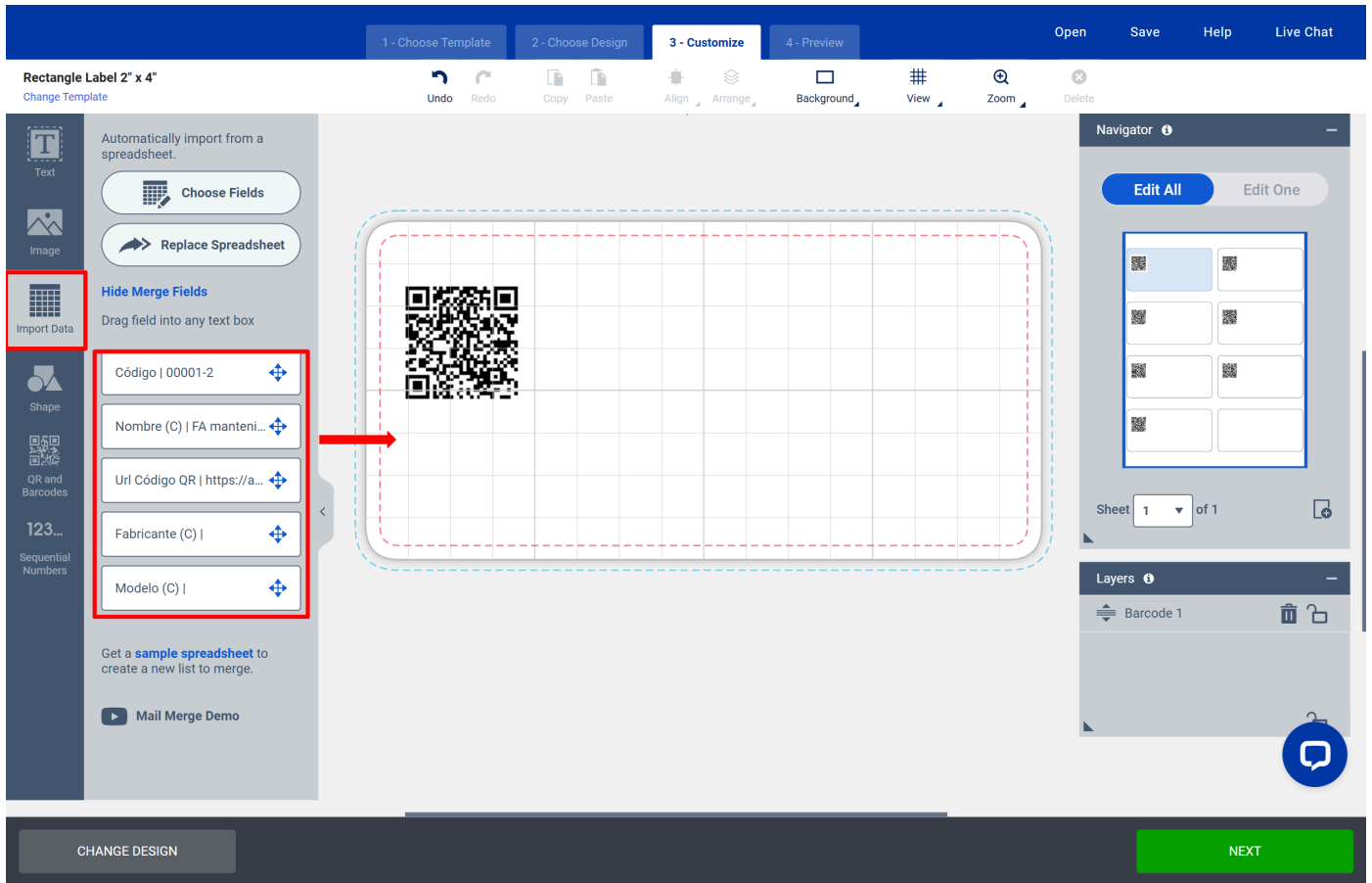

Adjust the size of the QR code and information to ensure they are legible.

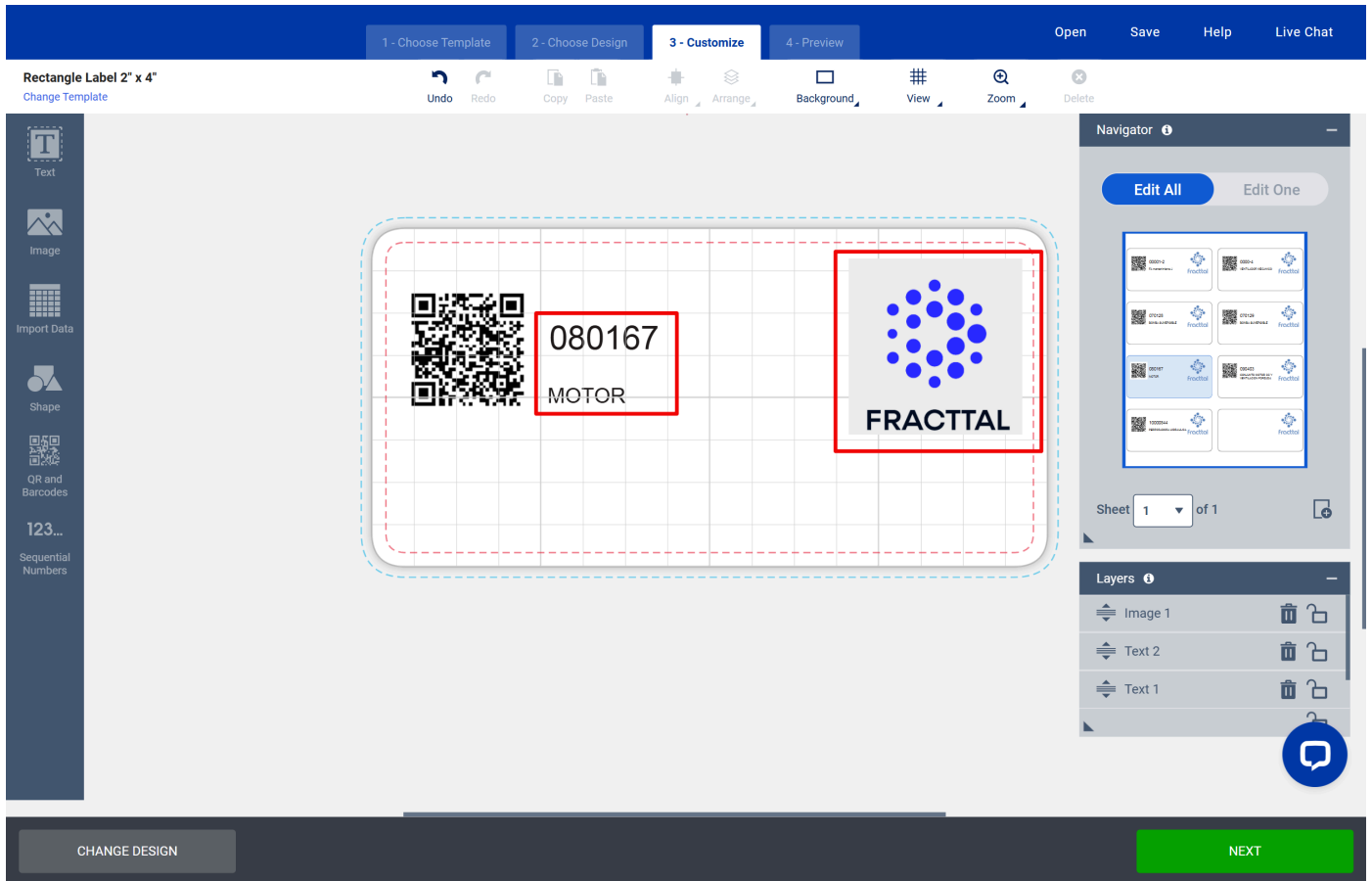

Step 6: Customize the Label

In Avery, you can customize the label design. This includes:

- Resizing the QR code and other elements.
- Adding the company logo or other relevant images.
- Adjusting colors, fonts, and the layout as needed.

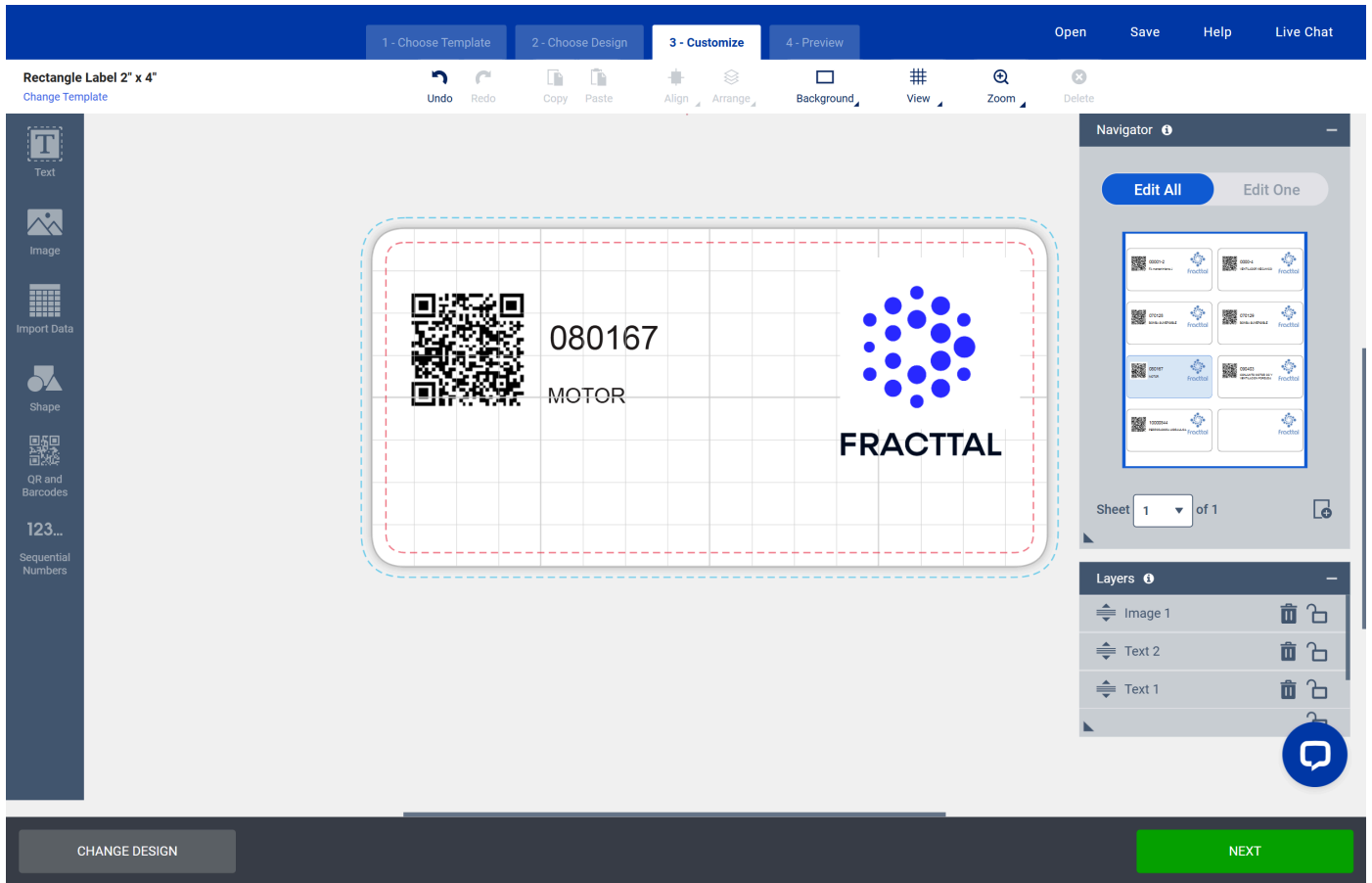

Step 7: Approval and Download of the Label File

After completing the design, click **"Next"** at the bottom right corner.

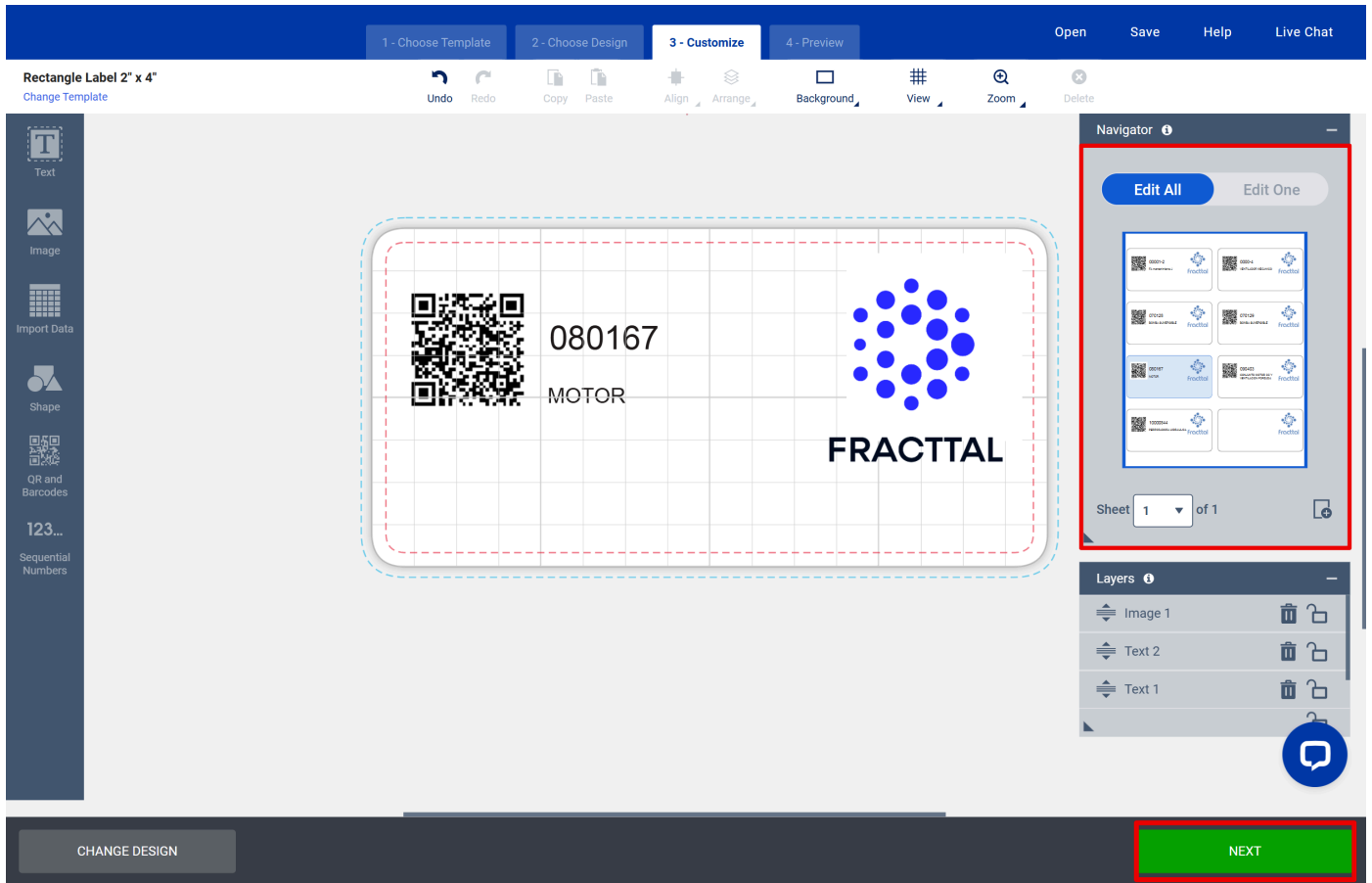

When finishing the label design, review the preview of the final result. If everything is correct, complete the process on the verification page. If needed, you can go back to make adjustments or, otherwise, approve the design to proceed with the download.

1 - Choose Template 2 - Choose Design 3 - Customize **4 - Preview** Open Save Help Live Chat

Rectangle Label 2" x 4" Preview Sheet: 1 / 1 Zoom

Change Template

Custom Printing

[View my PDF proof](#)

Double Check

- I spelled everything correctly
- I placed text and images to my liking
- I included all important details

I APPROVE MY DESIGN

[Edit my design](#)

Print Yourself

[Convert project to print yourself](#)

EDIT DESIGN

- To download the file as a PDF, click **"I Approve My Design"**.
- Then, on the next screen, you can click **"GET PDF TO PRINT"**. The file will be automatically saved to your computer.

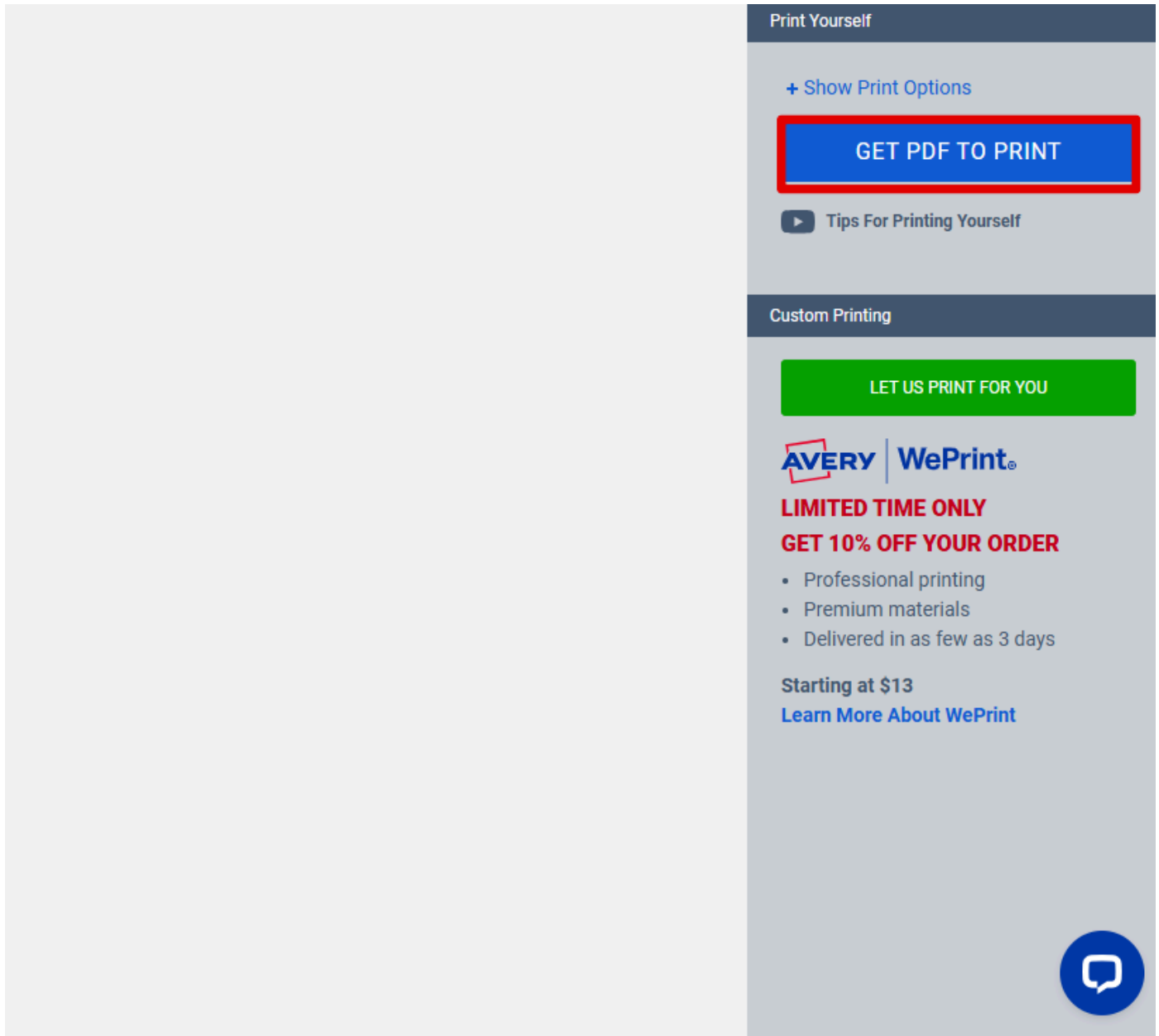

Once these steps are completed, you just need to print the customized labels with the desired data and apply them as needed.

Notes:

- The platform supports files in xls, xlsx, and csv formats.
- Files must have fewer than 3,000 rows, 20 columns, and be under 600 KB. If the file is larger, split it into multiple projects.
- Ensure the print settings are correct for the type of label chosen.